

Franklyn James



Elite House, 15 St. Annes Street

Limehouse, London, E14 7PT

Offers In Excess Of £450,000

Superbly positioned just beside the Limehouse Cut, is this wonderful two bedroom apartment that offers a versatile, modern layout. This contemporary apartment offers approximately 650 of well-proportioned space with two excellent size bedrooms, that comfortably house double beds. The open plan reception room and kitchen is dual aspect and designed with modern lifestyles in mind. A large balcony can be accessed from the reception and has lovely views over Limehouse Cut. There are two bathrooms (one of which is an en suite) as well as a good level of storage. Additional benefits include a high level of natural light thanks to plenty of large windows, a lift to the building, residents roof garden and a concierge.

Elite House forms part of the Canary Gateway development in Limehouse and is therefore fantastically located for all the area has to offer. Historic Narrow Street is just a short walk away, offering a wide range of eateries, restaurants and pubs, whilst the extensive amenities of Canary Wharf are within easy reach. Local residents enjoy walking, cycling and running along the water, as well as having the benefit of local gems such as Moo Canoes. The C3 Cycle Superhighway is nearby, as is Limehouse Station that offers regular DLR and C2C services, giving superb connectivity to key locations inside and outside London.

- Canal View
- Private Balcony
- Abundant Natural Light
- Two Bathrooms
- Double Bedrooms
- Modern, Stylish Interior
- Highly Convenient Location
- Superbly Connected

Viewing

Please contact our Limehouse Sales Office on 02077911777 if you wish to arrange a viewing appointment for this property or require further information.



Floor Plan

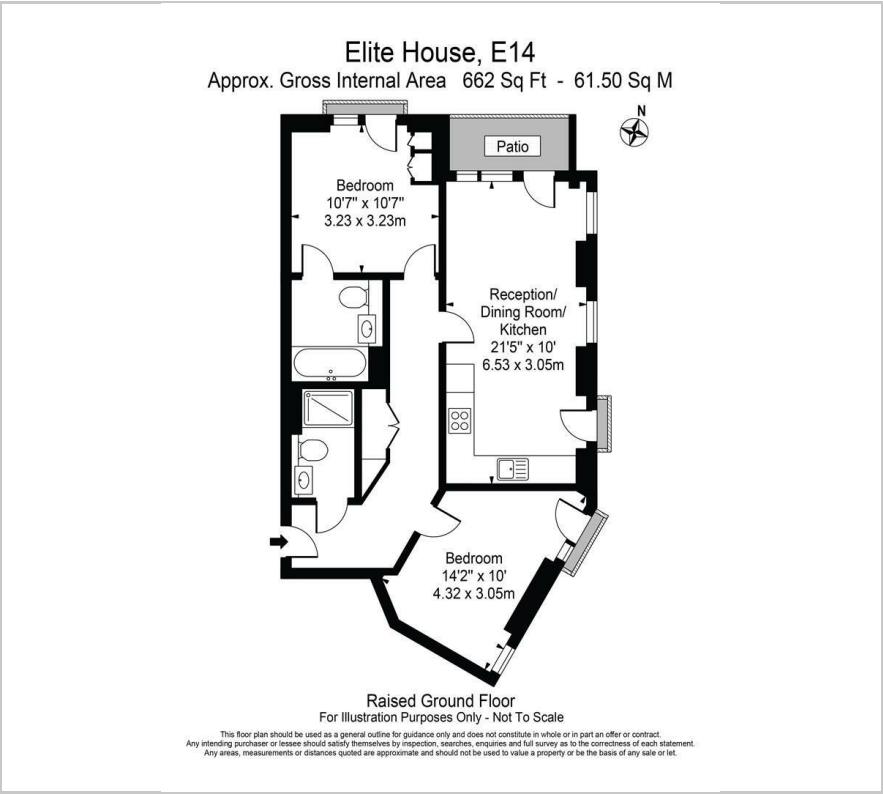

Area Map



Energy Efficiency Graph

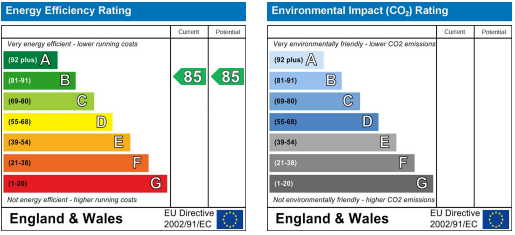

These particulars, whilst believed to be accurate are set out as a general outline only for guidance and do not constitute any part of an offer or contract. Intending purchasers should not rely on them as statements of representation of fact, but must satisfy themselves by inspection or otherwise as to their accuracy. No person in this firm's employment has the authority to make or give any representation or warranty in respect of the property.